



“Fly Away” Workshop with Sue Pritt



Thank you for signing up for our workshop with designer/teacher, Sue Pritt.
Learn or brush up on techniques of raw-edge fusible appliqué, free motion quilting,
and quilting ‘as-you-go’; with hints, tips and fun throughout the day!

We’ll be sandwiching and quilting at this class, so
please have your backing & batting ready to go!

And, besides your pattern & fabrics, please bring the following . . .

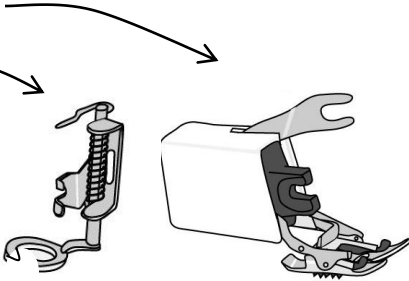
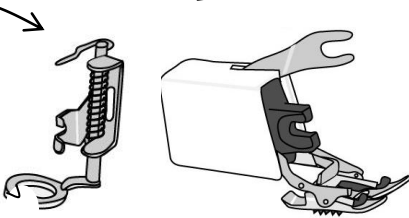
- __ sewing machine (oiled, cleaned and must know how to thread & use your machine)
- __ walking foot (VERY IMPORTANT!) 
- __ free-motion foot (darning) 
- __ threads to match appliqué pieces
- __ filled bobbins to match appliqué
- __ extra needles & extra bobbins
- __ rotary cutter with new blade
- __ rulers: __24” ruler __12 ½”square
- __ cutting mat -18”x 24” is a good size
- __ 505 basting spray (no others allowed, please)
- __ safety pins if NOT using spray
- __ small appliqué scissors with micro-sharp points
- __ long straight pins & magnetic pin holder
- __ quilting gloves (*very helpful!*)
- __ erasable OR washable fabric marking pen or pencil
- __ appliqué pressing sheet
- __ iron and ironing pad (unless supplied by shop or guild)
- __ lunch and beverage (Chocolate is always good, too!)

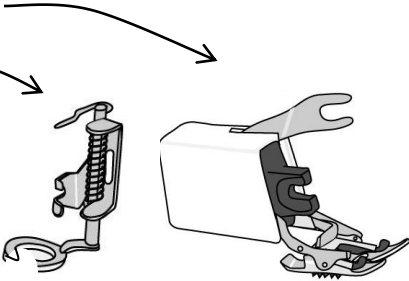

These may be
supplied by shop

*** If you do not have a walking foot OR appliqué foot – please buy or borrow them! They are required for this class!**

*** PLEASE * PRECUT
your
Backing Fabric
and Batting!
30” x 40” each
See reverse side for
more pre-cutting!**

Turn page over for your “Jump Start” directions

“Jump Start” for cutting AND making appliqué for “Fly Away”

If you have done fusible web appliqué before you may want to get a jump start on the fusing and cutting, HOWEVER, the following directions are *ONLY* if you feel comfortable doing some things on your own.

Step 1. Cutting the “B’s” .

Backing & Batting - Cut *each* 30”w x 40”h, set aside.

Binding - Cut 4 strips – 1½” x WOF

(*this is for single fold binding*)

You MAY cut and make the background before class

. (on NOT, and wait till class!)

__ From the THREE light blue fat quarters - cut EACH into 5½” x 18” strips – then cut into 5½” squares. You’ll need a total of 24 squares – (there will be extra squares)

__ From the THREE navy blue fabrics – cut EACH strip into seven rectangles - 5½”x 3½” (need total of 20 rectangles)

__ From red fabric – cut into four 3½” squares.

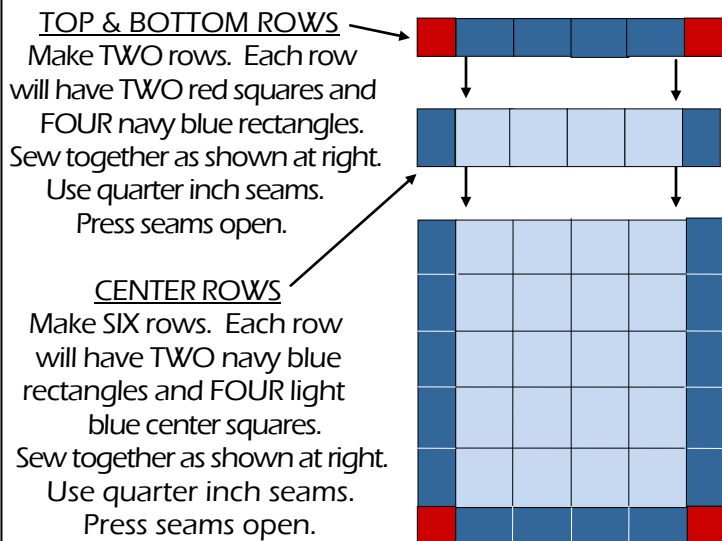

Complete the background as shown above, sewing all eight rows together with quarter inch seams.

Press seams open.

Step 2. Trace OR photocopy all the appliqué patterns from pages 2 thru 8, onto the paper side of fusible web sheets. Use either a light fusible web for tracing – OR – Use “printable” fusible web sheets with your inkjet printer. ✎ Cut apart the sections of the fusible sheet(s) on dashed lines, if any. ✎

✎ **Do NOT trace or photocopy pages 9, 10, and 11. They are the placement guides, not patterns!**

Step 3. Fabrics – use unwashed fabrics (OR washed fabrics, but do NOT add fabric softener).

TIP: Batiks are *always* best for raw edge fusible web appliqué!

Step 4. Cut your fabric to the size listed on each section of the appliqué pages.

Step 5. Fusing, lay fabric, ✎ RIGHT SIDE DOWN ✎ on ironing pad. Lay your printed (or traced) fusible web sheet, sticky side down over fabric. The paper side that you traced or photocopied will be facing up.

Step 6. With a hot iron (wool or cotton setting), PRESS the fusible web sheets to the fabrics - do NOT slide the iron around, instead “lift and press”.

NOTE: some fusible web sheets do NOT need to be ironed to the fabrics – instead they only need to be PRESSED by hand (ex: Lite Steam-a-Seam2) – Always read the instructions that accompany your fusible web!

Step 7. Lay out five ziptop baggies and label them; “A”, “B”, “C”, “D” & “E”.

Step 8. After fusing all the appliqué sheet sections to your fabrics, cut out the patterns on the traced lines. TIP: for tiny pieces, just cut a quarter inch margin all around shape, you’ll cut them out completely in class! ✎ Do NOT peel the paper from the appliqué pieces.

Step 9. As you cut out the pieces, place them in baggies according to their part number. Example, all “A” pieces in the “A” baggie, and all “B” pieces in the “B” baggie, etc., etc.

Step 10. Be sure to bring all your baggies to class, AND any leftover fabrics. You never know if you might need a bit more! 😊

See You SOON!

Sue Pritt